

800 WASHINGTON AVENUE NORTH  
MINNEAPOLIS, MN 55401

TRACTORWORKSBUILDING.COM

TRACTORWORKS  
BUILDING



Suite 400 | 56,314 SF

*divisible to 20,000 SF*

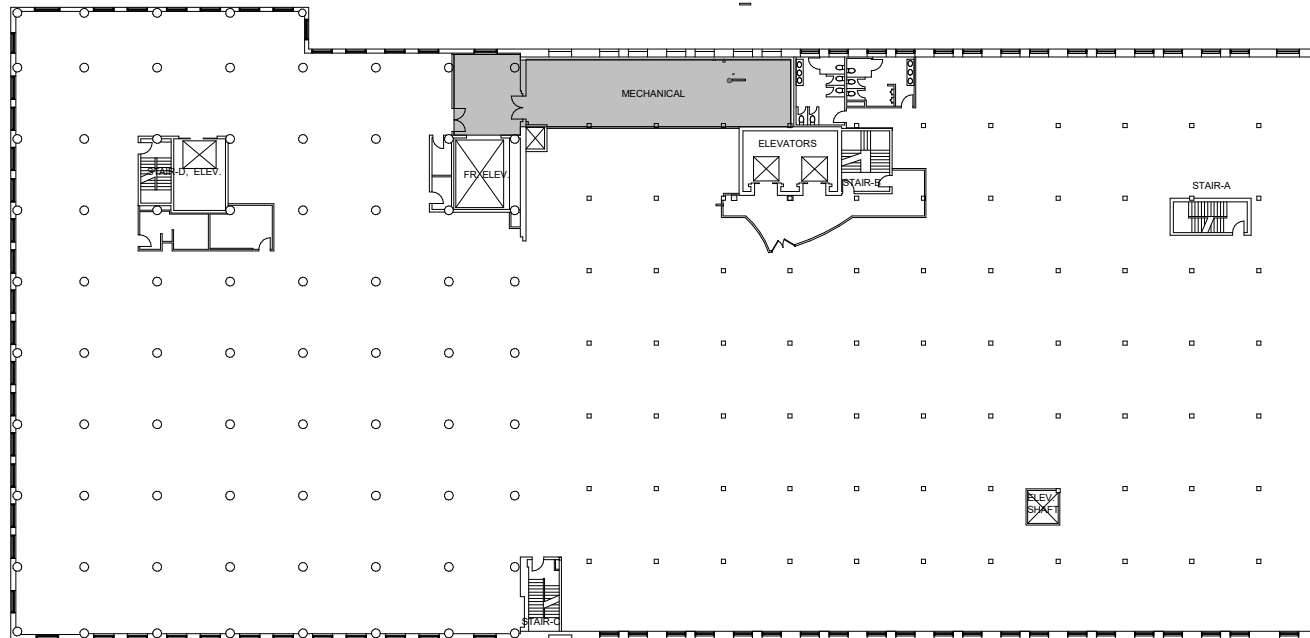

KEY PLAN:

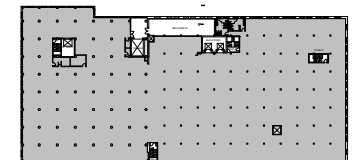

**NEWMARK**

FOR LEASING INFORMATION, CONTACT:

**Brent Erickson**  
612.430.9970  
brent.erickson@nmrk.com

**Callie Ronkowski**  
612.430.9975  
callie.ronkowski@nmrk.com